

RUSH CREEK

ENTRANCE ↗

Cemetery

McGuire Road



McHenry County
CONSERVATION DISTRICT

815.338.6223 • MCCDistrict.org

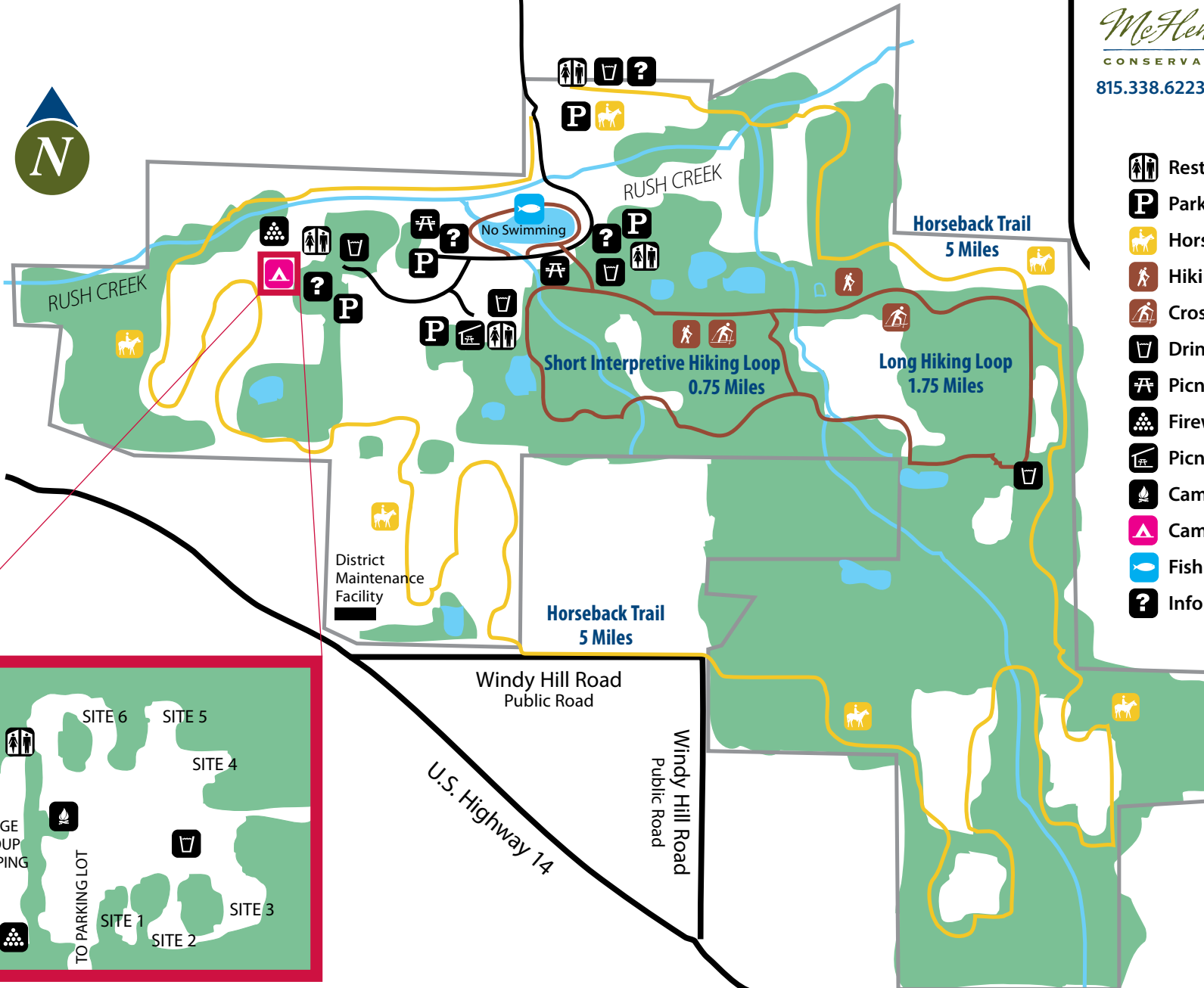

- Restrooms
- Parking
- Horse Trail
- Hiking
- Cross Country Skiing
- Drinking Water
- Picnicking
- Firewood
- Picnic Shelter
- Campfires
- Camping
- Fishing
- Information

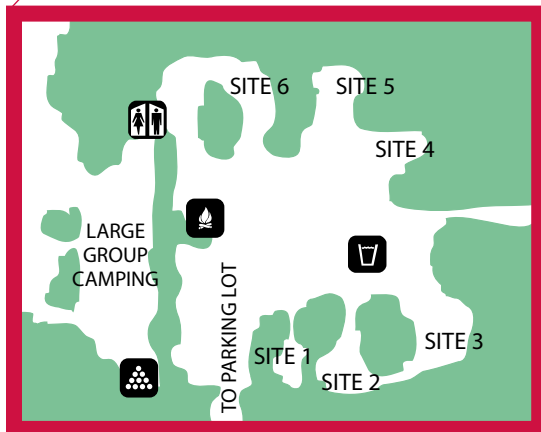

RUSH CREEK CONSERVATION AREA

SITE OPEN SUNRISE–SUNSET
ENTRANCE GATES OPEN 8 AM

20501 McGuire Road, Harvard

Main entrance GPS Coordinates:

N42°24.442
W88°35.948
WGS84



McHenry County
CONSERVATION DISTRICT

815.338.6223 • MCCDistrict.org

Printed with soy ink on recycled paper.

03/09 3000 (BRN)

RUSH CREEK CONSERVATION AREA



McHenry County
CONSERVATION DISTRICT

LOCATOR MAP

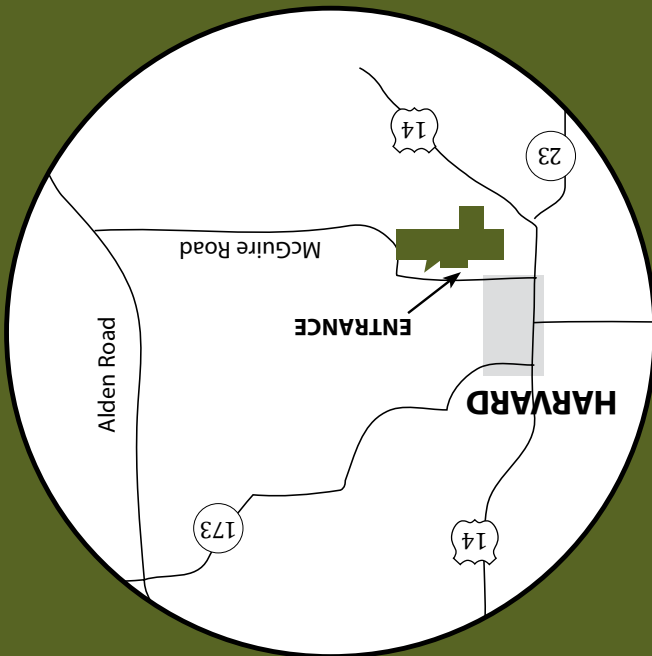

RULES

- Site hours are sunrise to sunset or as otherwise posted.
- Use authorized parking areas only for all vehicles.
- Picnics authorized in designated areas. Groups of 16 or more must secure a permit in advance from the District office. A fee is required to reserve a shelter.
- Alcohol may not be consumed within 100 feet of a parking area. The sale of alcoholic beverages is prohibited.
- Pets must be leashed at all times.
- Camping allowed by advance permit only and is confined to those areas designated as such. Permits are available at the District office, fee required.
- Fires permitted in designated areas only.
- Bicycles allowed only upon the roadways, parking areas and designated bicycle trails.
- Swimming is prohibited.
- All regulations of the Illinois Department of Natural Resources shall apply for fishing unless otherwise posted.
- No person shall in any way remove, disturb, harm, or destroy plant or animal life within conservation areas.
- The introduction of any plant or animal into an area is prohibited. Feeding of wildlife is also prohibited.